

Welcome to digital TV



For a one off payment, you can buy a digital box, satellite dish and installation giving you over 140 channels covering the best of TV and more.

The big switchover

Over the next 4 years, the old analogue TV signal is gradually being switched off. Soon you'll only be able to watch television with a digital receiver.

www.digitaluk.co.uk also offers information about when the analogue signal is being switched off in your area.



A digital box lets you access digital channels that are broadcast in the UK. It uses a digital signal, received through your satellite dish and lets you watch it through your existing television.

Need extra information or help setting up?

You may find the information you are looking for on our website.

www.bushdigital.co.uk

or on the freesat website.

www.freesat.co.uk

If you still need help or information you can phone our call centre on:

0871 230 4695

Calls are charged at 10p per minute when called from a BT land line. Call charges may vary if using other networks.

BUSH

BFSAT02SD
SD digital box

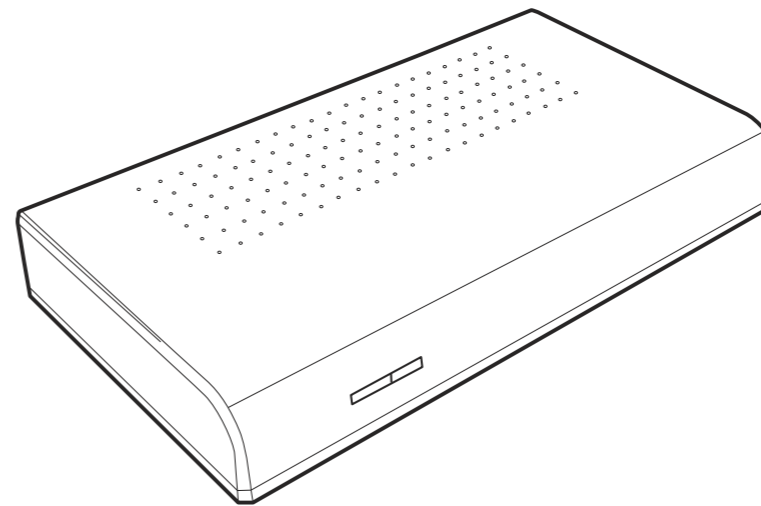

Start here

1

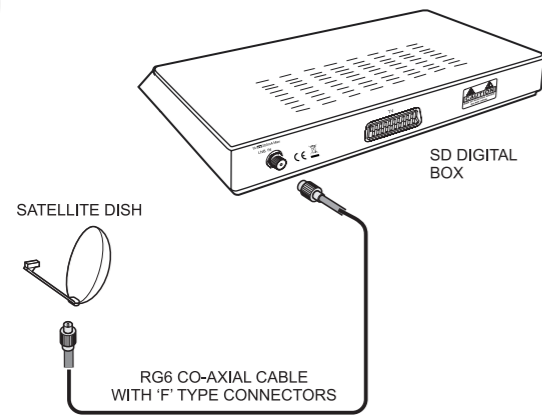

Connect a RG6 co-axial cable fitted with an 'F' type connector from your satellite dish to the 'LNB IN' socket on the back panel of the digital box.

2

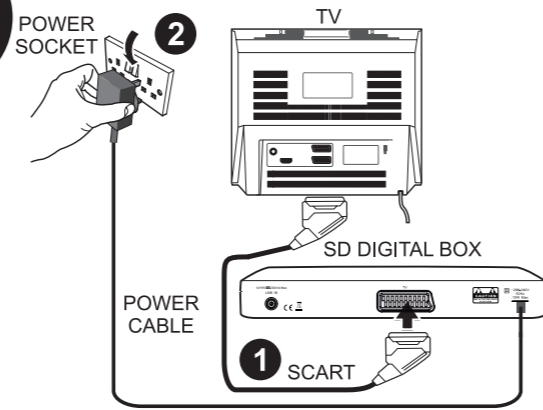

Connect the SCART cable that came with your digital box between the TV socket on the back panel of your digital box and the SCART socket on your TV. Connect the mains plug and then turn the power socket On.

3

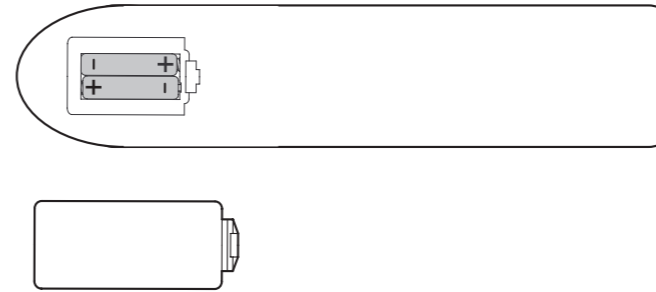

Open the battery cover of the remote control and put 2 x AAA batteries into the battery compartment.

4

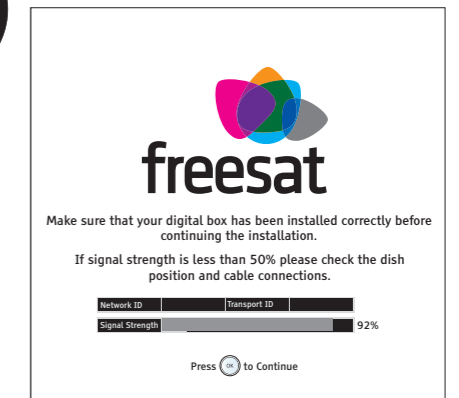

If the signal strength is above 50% press the OK button on your remote control. If the signal strength is below 50% you may need to reposition your satellite dish and check the connecting cables.

5

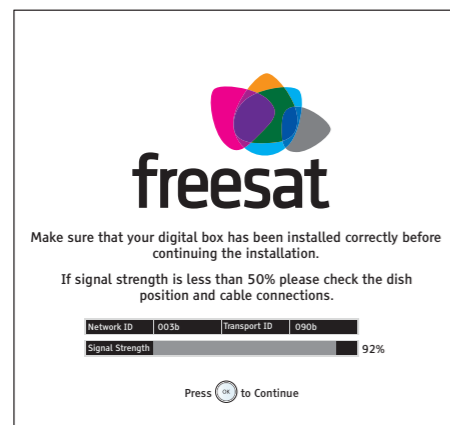

The digital box will search for the Network ID and Transport ID. When these have been found, press the OK button on your remote control.

6

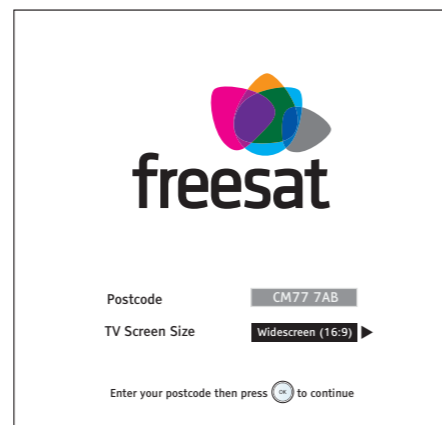

Use the number keys on the remote control to enter your postcode. There is no need to put a space in your postcode; this is done automatically by the digital box. The left arrow deletes the previous character. Press the OK button to continue.

7

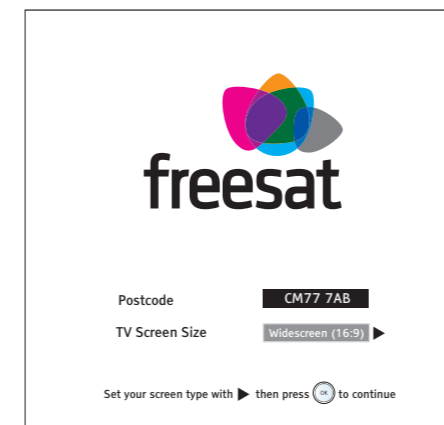

Use the right arrow to choose the TV screen size that matches your TV. Press the OK button to continue.

8

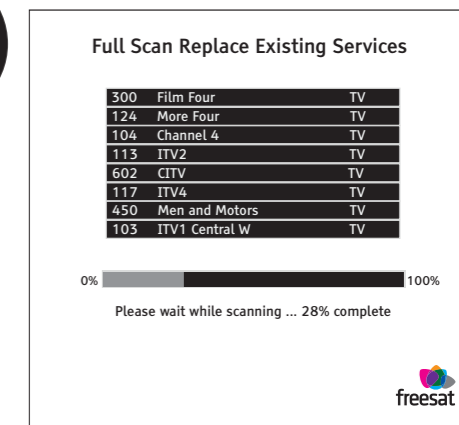

Your digital box will now autotune. This may take a few minutes.

9

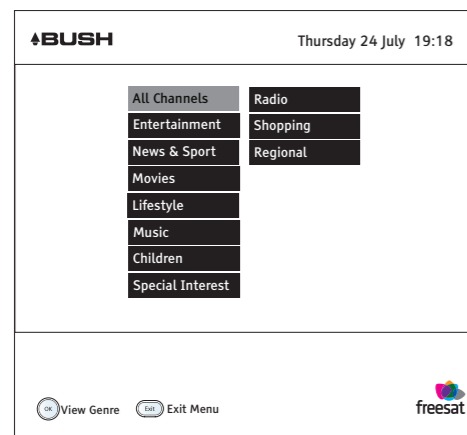

Press the GUIDE button on your remote control to see the channel types available.

You are now ready to watch tv.

To learn more about your digital box look in the main instruction manual.